

ALTON 1-PC TOILET INSTALLATION INSTRUCTIONS

Thank you for selecting our AXENT Switzerland. To ensure that your installation proceeds smoothly, please follow these instructions carefully before you begin. Carefully unpack and examine all of the items you have selected.

ALL INSTALLATION PROCEDURES MUST COMPLY IN STRICT ACCORDANCE WITH APPLICABLE LOCAL PLUMBING AND BUILDING CODES.

PROFESSIONAL LICENSED PLUMBER IS HIGHLY RECOMMENDED FOR INSTALLATION.

Thank You For Choosing

We appreciate your commitment to AXENT quality. If you encounter any installation or performance problems, please don't hesitate to contact us 949-250-4576.

Thanks again for choosing AXENT Switzerland.

Before You Begin



CAUTION: Risk of personal injury or product damage. Handle with care. Vitreous china can break or chip if the product is handled carelessly

- ☐ Carefully inspect the new toilet for damage or missing parts.
- ☐ If the existing toilet does not have a supply shut-off valve below the tank, install one before installing the new toilet.

INSTALLATION INSTRUCTION

Model No. W375-2020

1

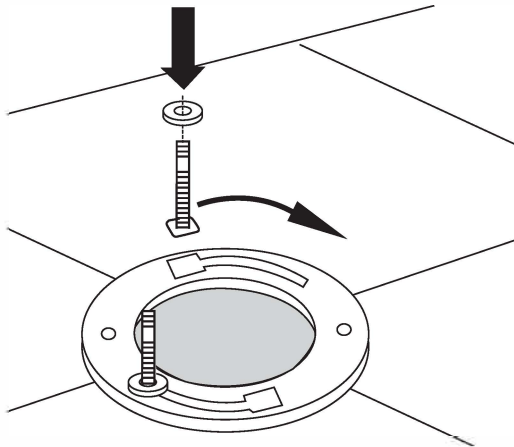

2

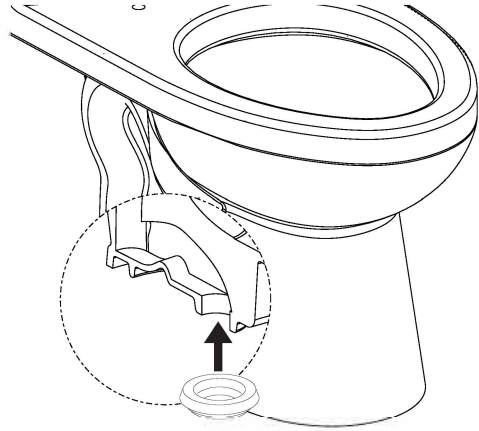

3

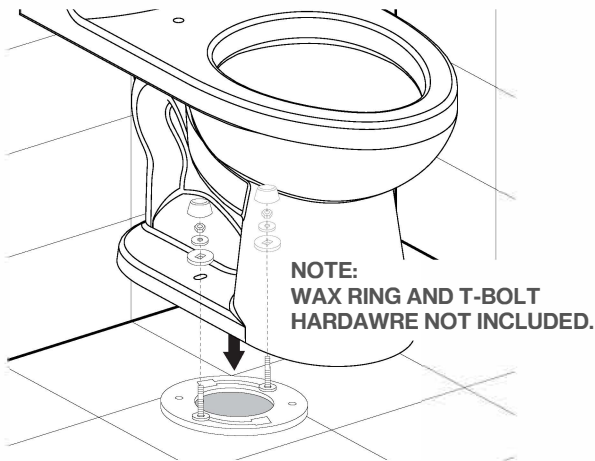

4



PARTS LIST

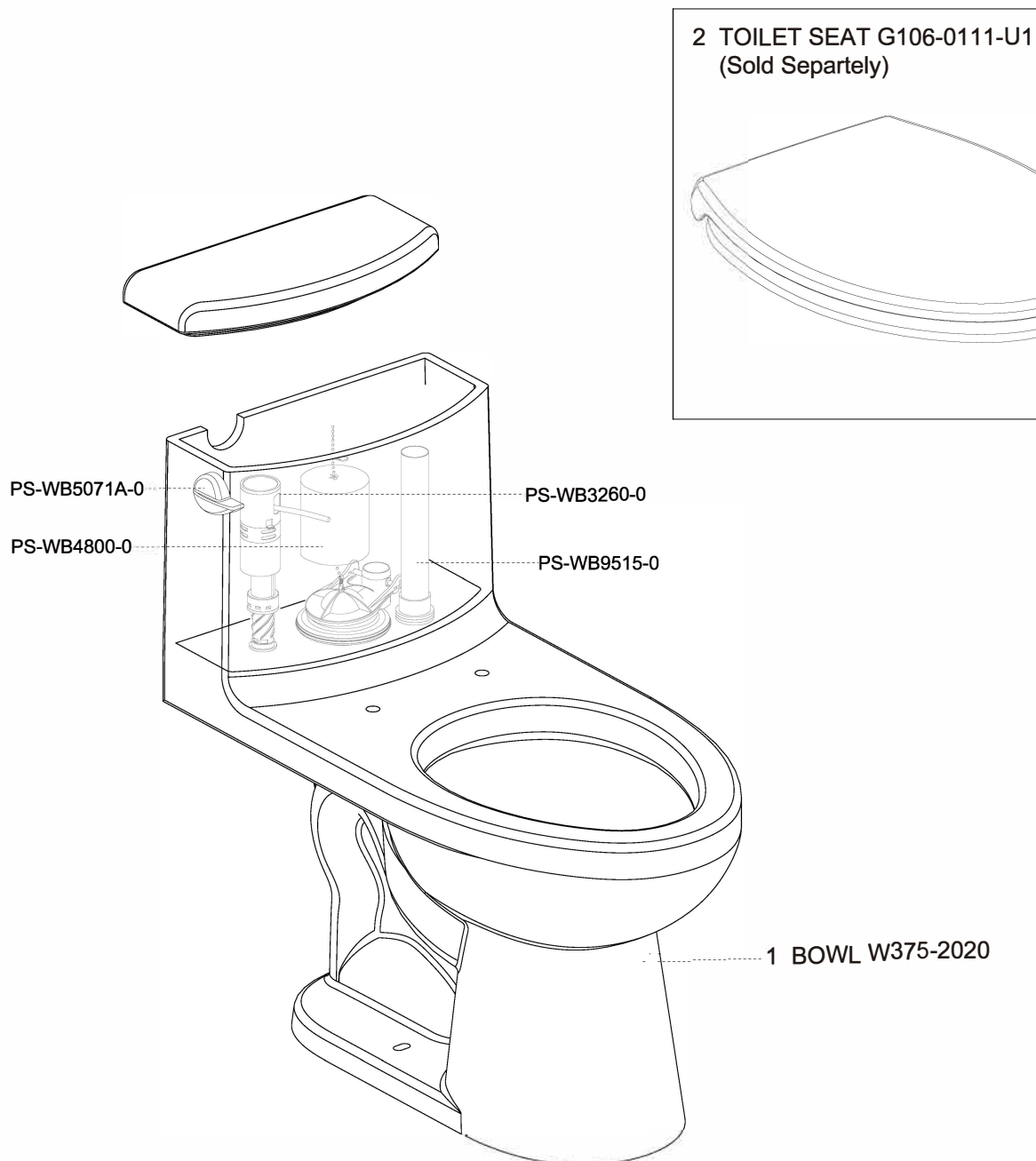

AXENT INTELLIGENC INC.

3 Musick
Irvine CA 92618
Telephone: 949-250-4576
Fax: 949-770-2902
Email: support@axentproducts.com
Website: www.axentbath.com